

INSTALLATION INSTRUCTIONS

DESCRIPTION: Front A-Arm Cover Kit
 PART NUMBER: B57-F31A0-V0
 MODEL: 16' ~ YZX1000R



⚠ WARNING

Please read and understand these instructions completely before installation to avoid possible injury, or damage to the accessory or vehicle.

NOTICE:

This installation requires a torque wrench and should be performed by an authorized Yamaha dealer or other qualified technician.

WARRANTY INFORMATION:

Genuine Yamaha Accessories are covered by a one-year limited warranty against defects in material or workmanship. Labor for replacement of defective components is not covered. See your Yamaha dealer for a copy of the warranty statement.

DEALER OR INSTALLER:

These instructions contain important information for future reference and *must* be given to the customer.

PARTS LIST:

No.	Part Number	Description	Qty
--	B57-F31A0-V0	Front A-Arm Cover Kit	--
①	*	Right A-Arm Cover	1
②	*	Left A-Arm Cover	1
③	*	Left Inner Bracket	1
④	*	Right Inner Bracket	1
⑤	*	Outer Bracket	2
⑥	*	M6 Washer	20
⑦	*	M5 x 16mm Hex Head Bolt	6
⑧	*	M6 x 20mm Button Head Bolt	16
⑨	*	M6 x 16mm Button Head Bolt	4
⑩	*	M5 Nylock Flange Nut	6
⑪	*	M6 Nylock Nut	16

* Part supplied with kit only and not available separately.

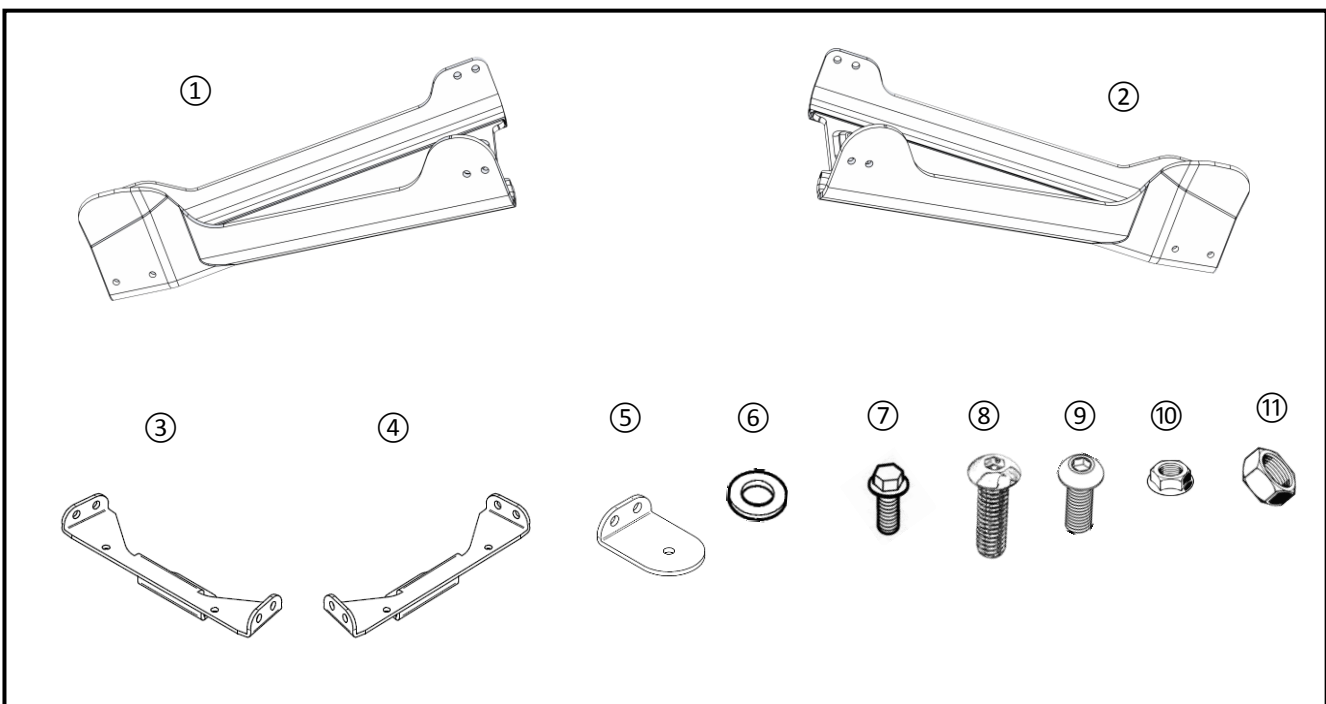

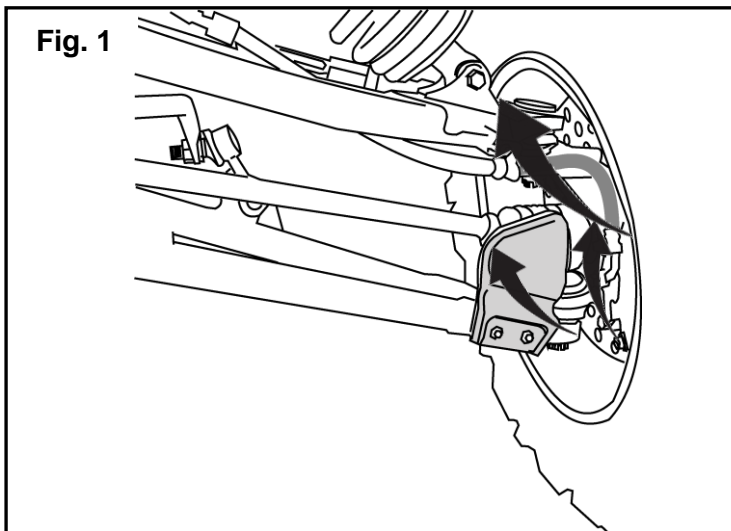

PREPARATION:

- Place the vehicle on a secure and level surface.
- Set the parking brake.
- Clean the mount surfaces before starting installation.

INSTALLATION:

1. Working from the front left side, remove 2 bolts used to secure the stock plastic protector (Fig. 1) to the A-Arm. The protector and the bolts will not be reused for this installation.
2. Install the Inner Left Bracket (3) to the A-arm. Use 2 M5x16mm bolts (7) to secure the bracket to the arm. Thread into M5 Flange Nuts (10) and torque to 6Nm. See Fig.2.
3. Install an Outer Bracket (5) to the A-arm with 1 M5x16mm Hex Head Bolt (7). Thread into a M5 Flange Nut (10) and torque to 6Nm. See Fig. 3.

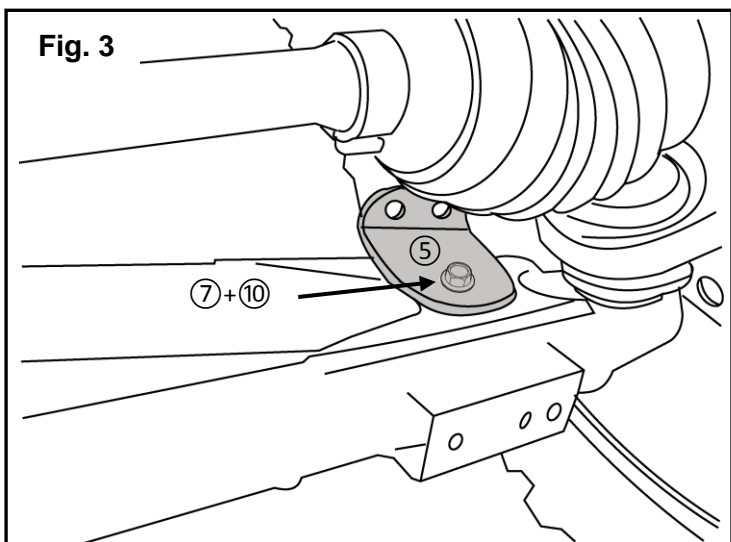
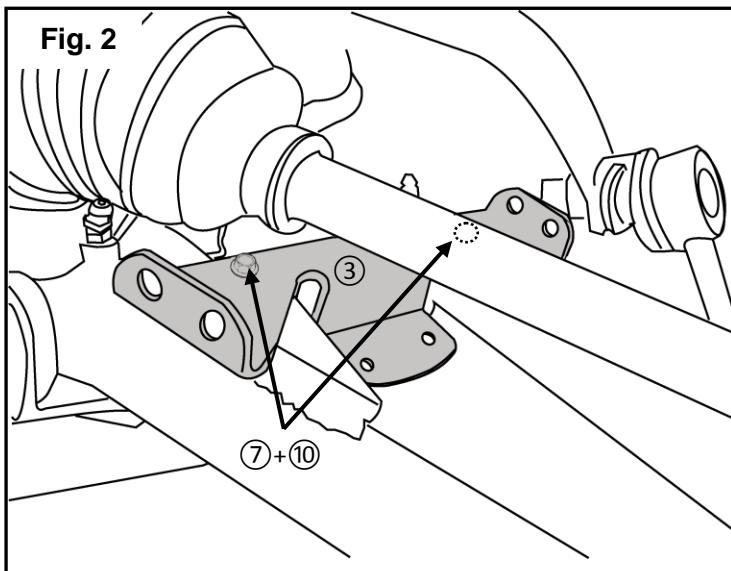

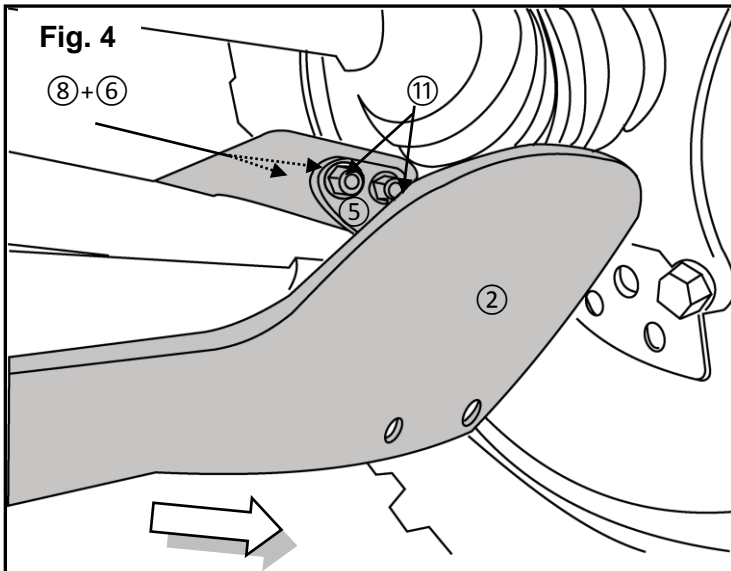

4. Hold the Left Arm Cover up to the A-Arm. Install 2 M6 x20mm Button Head Hex Bolts (8) with M6 Washers (6), from the outside, in through the A-Arm cover (2), through the Outer Bracket (5), and thread into 2 M6 Nylock Nuts (11). Torque to 7Nm. See Fig. 4.
5. Install 2 M6 x16mm Button Head Bolts (9) with M6 Washers (6), to the lower pre-drilled holes from the outside, in through the A-Arm cover (2), and thread into 2 weld nuts. Torque to 7Nm. See Fig. 5.
6. Move to the inboard side of the A-Arm guard and install 2 M6 x20mm Button Head Bolts (8) with M6 Washers (6), from the outside, in through the A-Arm cover (2), through the Left Inner Bracket, into 2 M6 Nylock Nuts (11). Torque to 7Nm. See Fig. 5.
7. From underneath, install 2 M6x20mm Button Head Hex Bolts (8) with Washers (6) up through the pre-drilled holes in the A-Arm guard (2), through the holes in the Left Inner Bracket (3), thread an M6 Nylock Nut (11) on to the Bolt. Torque to 7Nm.
8. Repeat the process on the right side.

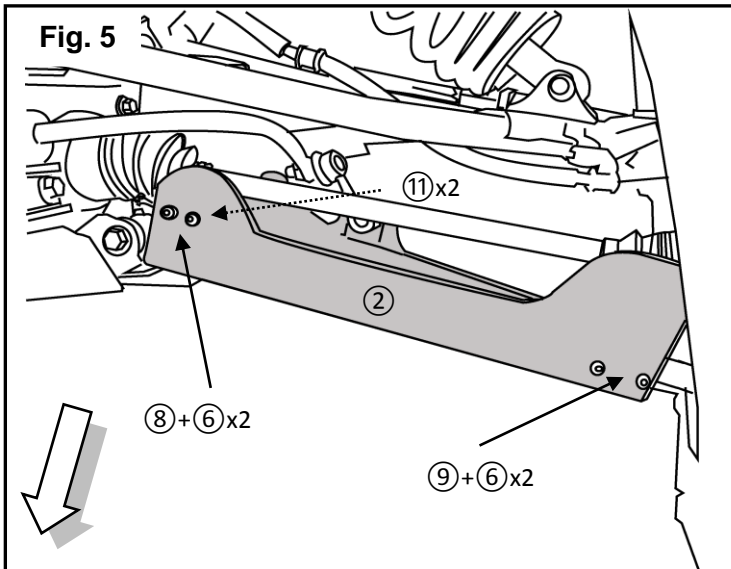

MAINTENANCE:

Periodically, check torque and tightness on all hardware. If loose hardware is found, re-torque or re-tighten.

CARE AND CLEANING:

Clean painted metal parts with a clean soft cloth and mild soap and water. Rinse and dry.

CUSTOMER SERVICE:

For further information see your Yamaha dealer.

ESTIMATED TIME TO INSTALL: 0.7 HR

